

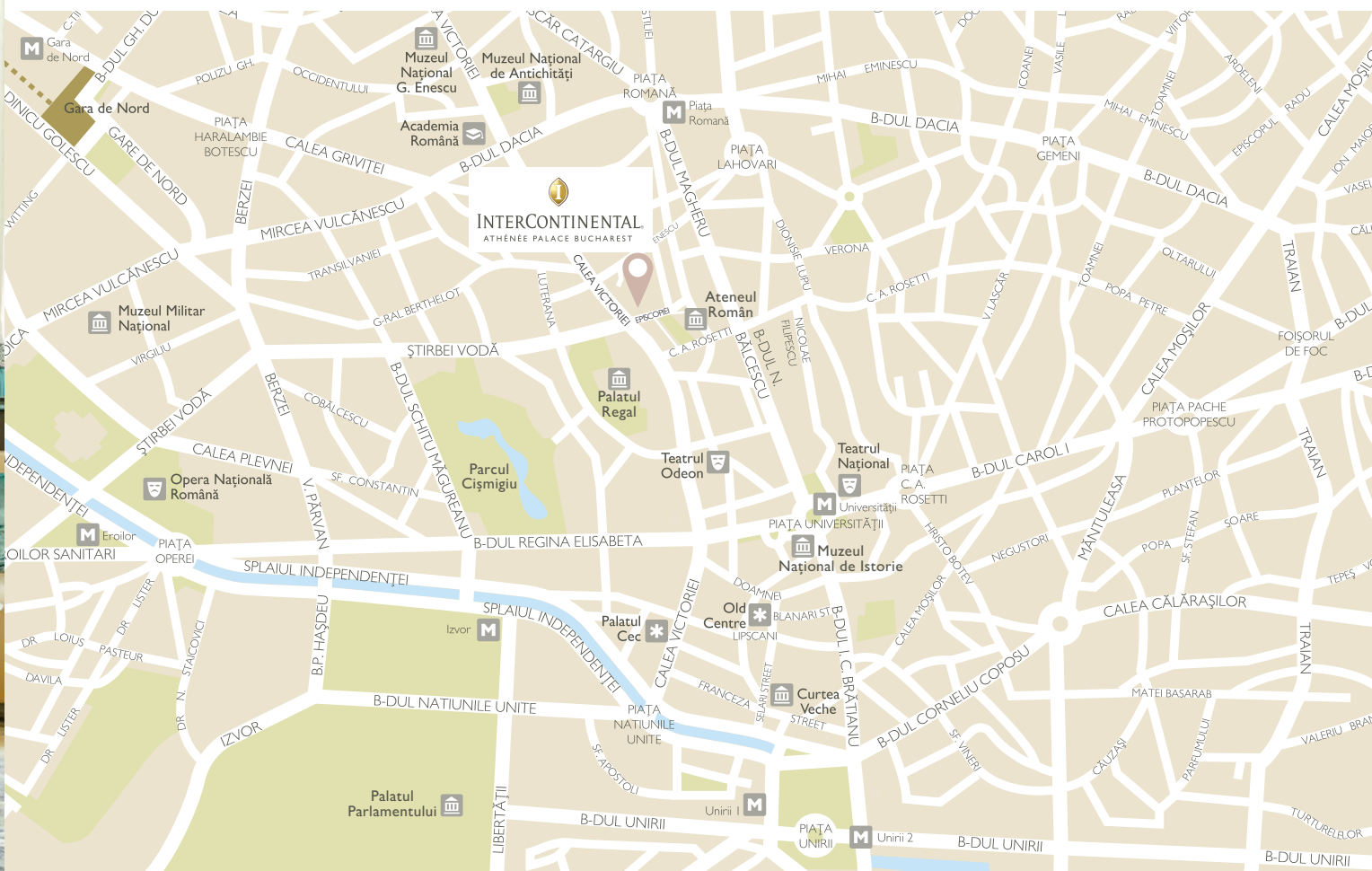

INTERCONTINENTAL[®]

ATHÉNÉE PALACE BUCHAREST

LIVE THE INTERCONTINENTAL LIFE



EPISCOPIEII 1-3, BUCUREȘTI, SECTOR 1
CONTACT: +40 21 305 3777 EMAIL: BUHAP.EVENTS@IHG.COM
ATHENEEPALACE.INTERCONTINENTAL.COM



INTERCONTINENTAL
ATHENÉE PALACE
MEETINGS & EVENTS

HERITAGE

Dating back to 1914, the building was inaugurated in an Art Nouveau style and in 1937 had its first major change to an Art Deco exterior, displaying a distinctive blend of heritage and contemporary. Here you'll be transported from the eclectic style façade into the au-courant lobby that overlooks the perennial Les Collonnades. The hotel began its life as a building serving the Royal Palace guests and over the years has received many transformations with the most current in 2022. In total, InterContinental Athenee Palace Bucharest houses 283 modern rooms and suites, with the Crown Jewel being the Queen Mary Royal Suite. This historic landmark presents a wealth of premium amenities, warm hospitality, and bespoke cuisine for both leisure and business guests.

LIMITLESS LUXURY

Our facilities feature 283 well-appointed guest rooms and suites, including our Palace Suites and Queen Mary Royal Suite. Thirteen function rooms are available, including the 305-square-meter Le Diplomate Ballroom and the 170-square-meter Queen Mary Ballroom, both with a private foyer. In total, we offer nearly 1000 square meters of meeting and event spaces. The InterContinental Athenee Palace is the ideal location for corporate gatherings, board meetings, conferences, and the city's most distinctive weddings and social events for 30 to 250 guests. You can count on white-glove support throughout your entire planning process. From booking to staging, our sophisticated international team of event experts will customize every detail, delivering seamless, stress-free events that exceed all expectations.

LOCALE

Located in the center of Bucharest, InterContinental Athénée Palace is just a few minutes' walk from tourist attractions, shops, and entertainment venues. Getting around is easy, with Henri Coanda International Airport just a 35-minute drive away.

EXPERIENCE

Discover the captivating experiences of Bucharest and its surroundings, from vibrant nightlife to historical landmarks, there's something for every visitor to enjoy. Immerse in all night parties at unique venues, indulge in culinary delights at local food markets, and explore the city's rich history through private tours with knowledgeable guides. You can also embark on a charming vintage train journey through picturesque landscapes or venture beyond the city to visit enchanting castles and breathtaking natural wonders. Let us curate moments that will leave your guests in awe.

RESPONSIBLE BUSINESS

At InterContinental Athenee Palace, we embrace economic prosperity, social responsibility, and environmental protection. Our sustainability strategy is in line with the United Nations' 2030 Agenda for Sustainable Development. With the 17 Sustainable Development Goals as our foundation, we strive to set the standard for the hospitality industry. Our commitment is evident in our culinary offerings, with nearly all food sourced as organic, seasonal, natural, or local. We prioritize waste management to reduce our carbon footprint, implementing initiatives such as recycling and minimizing paper consumption. We employ energy-efficient LED lighting, utilize smart aerators for water conservation without compromising pressure and optimize room temperature control through an intelligent BMS system. Experience a hotel that not only provides exceptional hospitality but also champions sustainable practices for a brighter future.

FLOORPLANS & CAPACITIES

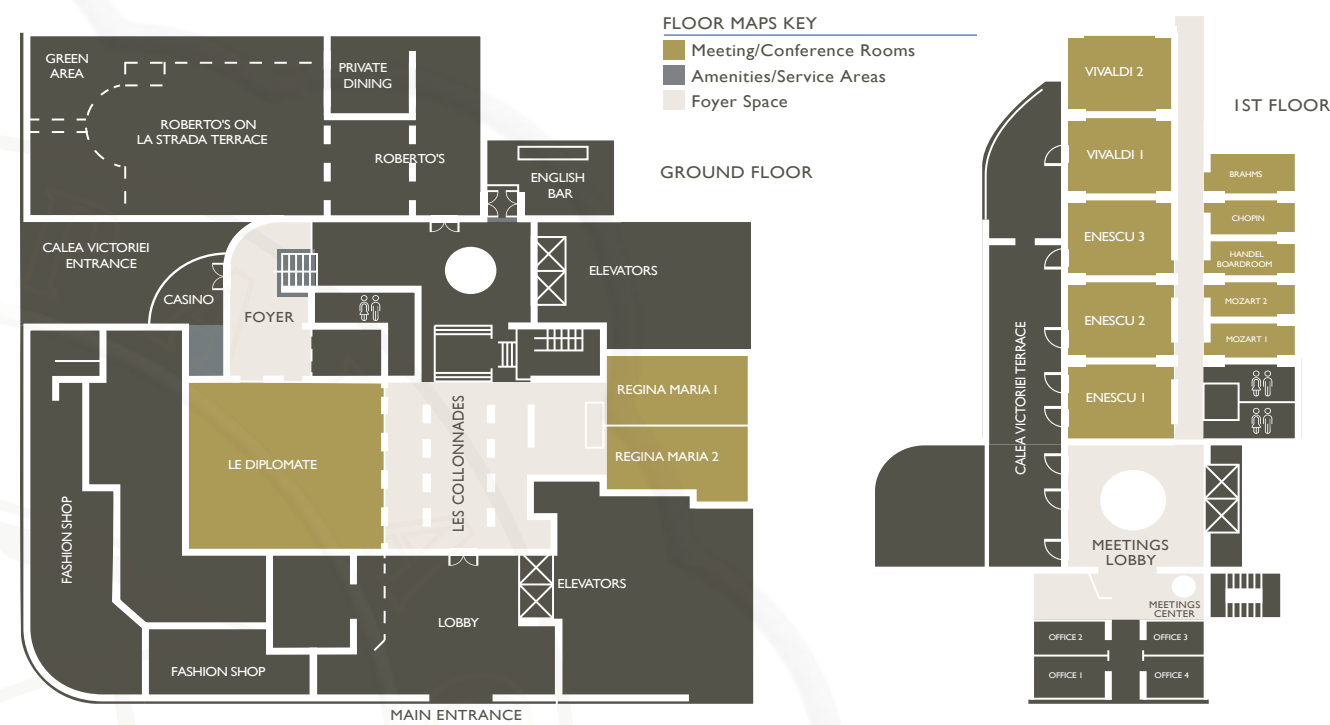

Name	Location	Area (m ²)	Classroom	Theatre style	Boardroom	U-Shape	Cocktail Reception	Cabaret Style	Banquet	Social Events
Le Diplomate	Ground Floor	305	190	250	50	80	250	128	220	180
Regina Maria I and II	Ground Floor	170	130	180	40	160	160	64	120	80
Regina Maria I	Ground Floor	85	65	90	30	35	75	32	50	30
Regina Maria II	Ground Floor	85	65	90	30	35	75	32	50	30

Name	Location	Area (m ²)	Classroom	Theatre style	Boardroom	U-Shape	Cocktail Reception	Cabaret Style	Banquet	Social Events
Enescu I	1 st Floor	72	30	60	26	25	50	32	40	30
Enescu II	1 st Floor	72	30	60	26	25	50	32	40	30
Enescu III	1 st Floor	72	30	60	26	25	50	32	40	30
Enescu I+II	1 st Floor	140	60	110	40	40	100	56	80	60
Enescu II+III	1 st Floor	140	60	110	40	40	100	56	80	60
Enescu I+II+III	1 st Floor	210	90	150	60	60	150	80	120	100
Vivaldi I	1 st Floor	70	30	50	26	25	50	32	40	30
Vivaldi II	1 st Floor	70	30	50	26	25	50	32	40	30
Vivaldi	1 st Floor	140	60	100	36	40	100	56	80	60
Mozart I	1 st Floor	32	16	20	14	n/a	20	n/a	n/a	n/a
Mozart II	1 st Floor	32	16	20	14	n/a	20	n/a	n/a	n/a
Mozart	1 st Floor	60	32	45	20	20	40	24	30	30
Handel Boardroom	1 st Floor	32	n/a	n/a	14	n/a	n/a	n/a	n/a	n/a
Chopin	1 st Floor	32	16	20	14	n/a	20	n/a	10	n/a
Brahms	1 st Floor	32	16	20	14	n/a	20	n/a	10	n/a

