

THE HOTEL

With over a century of tradition and excellence, Athénée Palace is a repository of countless unique and impactful events, each year enriched by the experiences of its guests.

The hotel's construction began in 1912, inspired by the French architect Téophile Bradeau, and its grand opening in 1914 marked a pivotal year in its history.

Characterized by its unique personality, InterContinental Athénée Palace appeals to travellers who seek a deeply integrated hotel experience. Combining historic charm with genuine hospitality, guests can indulge in a luxurious home away from home while exploring the vibrant city of Bucharest.



LOCATION

Surround yourself with culture and history just steps from our doors. From the grandeur of the Romanian Athenaeum to the elegance of the Royal Palace, and the significance of Revolution Square and Roman Square, our central location places you at the heart of Bucharest's most iconic landmarks.

GASTRONOMIC EXCELLENCE

The hotel offers a refined collection of dining experiences that celebrate both heritage and innovation. Step into the iconic English Bar, a historic gem where chandeliers and rich woodwork set the scene for timeless conversations — once shared by spies and writers alike. At Café Athénée, indulge in all-day dining where elegant design meets gourmet creativity, featuring trompe l'oeil culinary artistry and refined comfort dishes. For a bold and immersive experience, JORJ. delivers fire-and-ice-inspired flavors in a striking indoor-outdoor setting — a true destination for Bucharest's modern gastronomy.

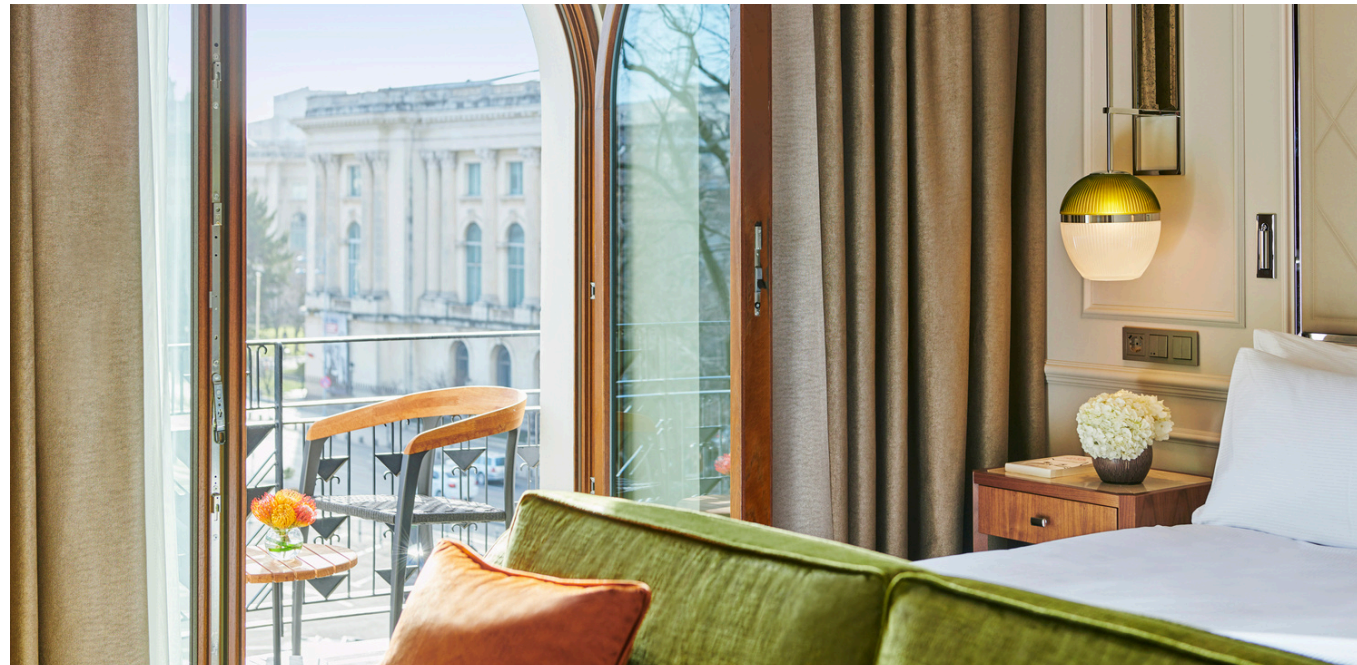

GUEST ROOMS & FACILITIES

Each of our rooms has its own identity and reveals exceptional décor with a modern design, featuring hand-finished oak floors. Designed by interior architect, Alexander James, our well-appointed rooms and suites offer exceptional luxuries and an unbeaten location right in the royal heart of Bucharest.

The 283 rooms and suites of the hotel combine style and comfort with upscale amenities and premium materials, offering a perfect blend of elegance and convenience for discerning travellers seeking a lavish experience. Each room possesses a distinct identity and showcases exceptional décor with modern design touches, including hand-finished oak floors.

In-room amenities feature include marble bathrooms with dual shower fixtures, full-size Byredo bath products, make-up mirror, hair dryer, flat screen televisions with international channels, high speed wireless internet access, individual climate control, iron and ironing board, safe, minibar, coffee maker, and terrycloth bathrobe with slippers. Laundry and dry cleaning services are available upon request.



CLUB INTERCONTINENTAL®

Join the Club - Club InterContinental® combines worldclass service and exclusive privileges to make your stay extra special.

We aim beyond the obvious, turning our attention to thoughtful touches and signature moments. Unlock your elevated experience by adding Club access to your reservation and enjoy the perks.



InterContinental Athénée Palace
Episcopiei 1-3, Bucharest
buhap.events@ihg.com | T: +40 21 303 799

MEETINGS & EVENTS

Discover the ideal venue for meetings and events at InterContinental Athénée Palace, offering 1850 sqm of flexible space. From intimate boardrooms to a grand ballroom accommodating up to 600 guests, our 13 versatile meeting rooms—10 with natural light and 3 with terrace access—cater to every occasion. With modern facilities, expert audiovisual support, outside catering options, and a dedicated meeting host, we ensure every event is seamlessly executed.

Among our standout venues, we take pride in Le Diplomate Ballroom—one of the best-preserved historical halls in Romania and officially listed as a National Heritage monument. Fully restored in 2022, this iconic space blends timeless elegance with modern functionality, accommodating up to 300 guests in a theatre-style setup.

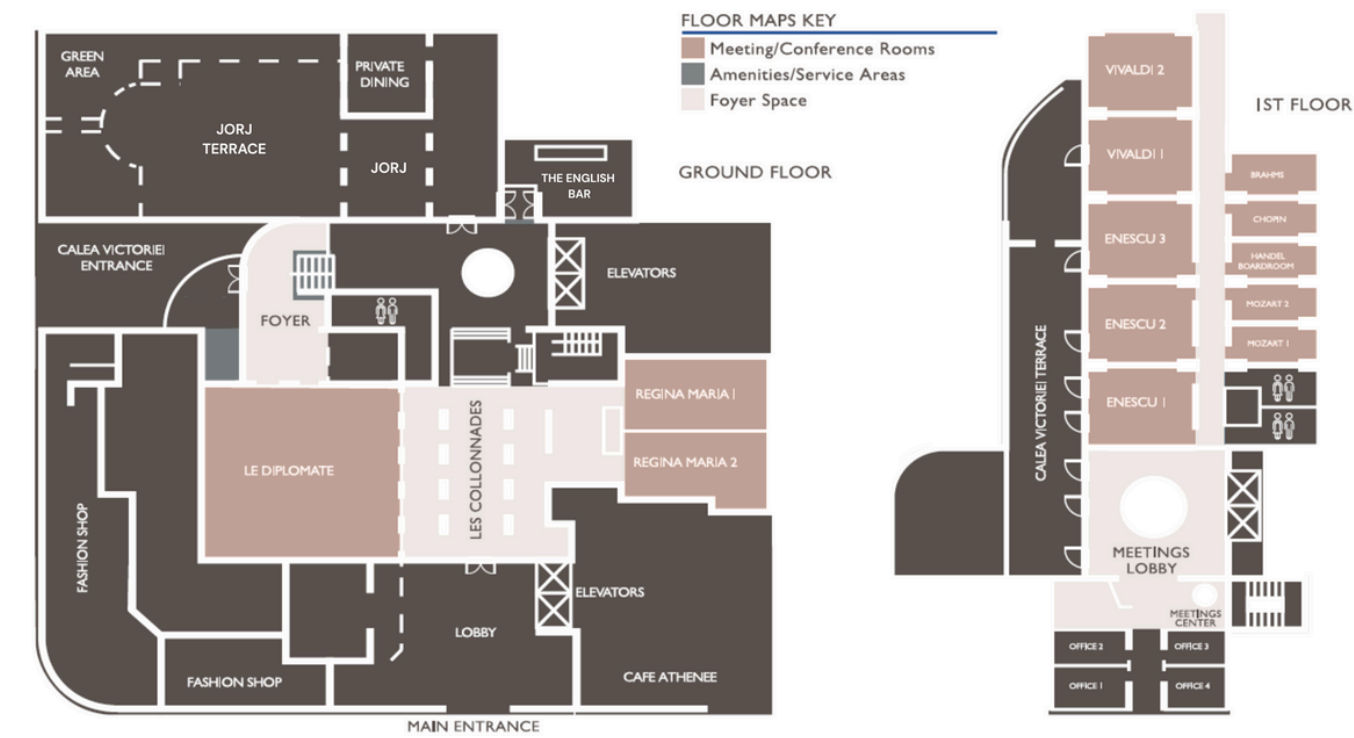

RESPONSIBLE BUSINESS

The InterContinental Athénée Palace Bucharest’s responsible business plan follows the guidance of our parent company, InterContinental Hotels Group, and focuses on the triple Bottom Line of Economic Prosperity, Environmental Protection and Social Responsibility. We aim for our sustainability strategy – which aligns with the United Nations 2030 Agenda for Sustainable Development – to become the benchmark of the hospitality industry. We pledge our commitment to Journey to Tomorrow launched by IHG Hotels & Resorts.

PERSONALISED SERVICE

Elevate your events to extraordinary heights at InterContinental Athénée Palace, where luxury meets impeccable service. Whether you're planning a refined wedding, an award ceremony, an international conference, or a glamorous gala dinner, our sophisticated meeting rooms provide the perfect setting to create unforgettable memories.



Name	Location	Area	Classroom	Theatre style	Boardroom	U-Shape	Cocktail Reception	Cabaret Style	Banquet	Social Events
Enescu I	1st Floor	72	30	50	24	24	50	32	40	30
Enescu II	1st Floor	72	30	50	24	24	50	32	40	30
Enescu III	1st Floor	72	30	50	24	24	50	32	40	30
Enescu I+II	1st Floor	140	60	100	40	40	100	56	80	60
Enescu II+III	1st Floor	140	60	100	40	40	100	56	80	60
Enescu I+II+III	1st Floor	210	90	150	60	60	150	80	120	100
Vivaldi I	1st Floor	70	30	50	26	24	50	32	40	30
Vivaldi II	1st Floor	70	30	50	26	24	50	32	40	30
Vivaldi I+II	1st Floor	140	50	100	36	40	100	56	80	60
Mozart I	1st Floor	32	14	16	12	n/a	n/a	n/a	n/a	n/a
Mozart II	1st Floor	32	14	16	12	n/a	n/a	n/a	n/a	n/a
Mozart I+II	1st Floor	60	24	36	20	20	40	24	30	30
Handel	1st Floor	32	n/a	n/a	12	n/a	n/a	n/a	n/a	n/a
Chopin	1st Floor	32	16	20	12	n/a	20	n/a	10	n/a
Brahms	1st Floor	32	16	20	12	n/a	20	n/a	10	n/a
Le Diplomate	Ground Floor	305	160	250	n/a	60	250	160	190	180
Regina Maria I and II	Ground Floor	170	120	180	40	40	160	120	120	100
Regina Maria I	Ground Floor	85	60	90	30	35	75	60	60	50
Regina Maria II	Ground Floor	85	60	90	30	35	75	60	60	50